



Defined by
**EXPERIENCE
EXPERTISE &
EXCELLENCE**

EN/ProductCatalogue/V5



ENCRAFT India Private Limited
A DCJ Group Company
70, Okhla Industrial Estate, Phase -III
New Delhi-110020 (India) Ph.: +91 11- 40922210
email: info@encraft.in website: www.encraft.in



Experience



Genesis



With the inception in 1961, the enterprise that today stands tall as DCJ Group, India's leading system-oriented conglomerate comprises 3 companies: Ajay Poly Pvt Ltd, ENCRAFT India Pvt Ltd and Ajay Industrial Polymer Pvt Ltd. The Group has innovated and introduced a number of Thermoplastic engineering products in India in its 5 decades of journey. Ajay Poly Pvt Ltd is among the largest manufacturers and suppliers of Refrigeration Sealing Systems for household and commercial industries in India catering to both multinationals and Indian white goods industries. The DCJ Group is also the largest manufacturer of a wide range of custom made extruded specialty profiles for various sectors.

Expertise

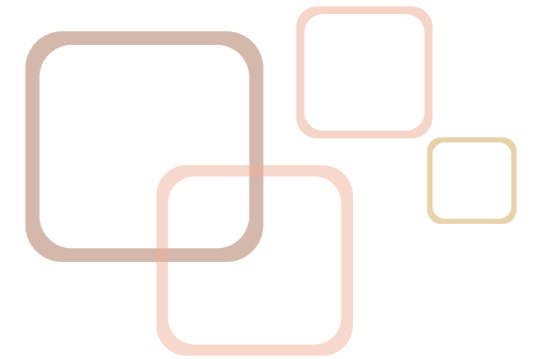

Ingenuity



ENCRAFT is a product brand of ENCRRAFT India Pvt. Ltd. ENCRRAFT Door & Window systems are engineered with precision and are masterpieces of art. Incepted under the leadership of Robert Hoellrigl an Austrian Engineer with over 40 years of experience in uPVC tooling and extrusion, earlier associated with WHS Halo, one of the UK's leading fenestration solution providers. ENCRRAFT's uPVC Door & Window systems offer a lifetime of style, strength and security. ENCRRAFT Door and Window Systems come in a range of customized designs and wood shades to match with all décors.

ENCRAFT Doors & Window Systems, which conforms to British, European and International quality standards, is made of the best raw materials to provide the best formulation for its uPVC profiles. This enables ENCRRAFT to deliver a profile system which is free of any kind of fading or decolorization, warpage & cracking for a very long period.

Excellence

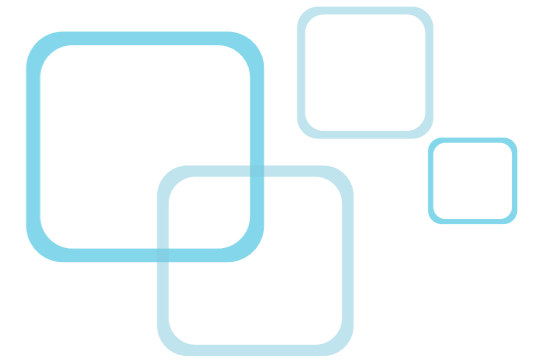

Supremacy

Free from lead (Pb) and other hazardous substances, and approved for green building concept, ENCRAFT Systems are designed for Indian tropical conditions and are extruded and tested conforming to BS EN12608. ENCRAFT Systems are designed and developed for a wide range of glass sizes varying from 4 mm to 36 mm. ENCRAFT Systems are a superior substitute for the conventional wooden frames taking into account the cost, strength, beauty, precision and ecology. Doors & Windows made of ENCRAFT engineered profile system, don't let Heat, Cold, Sound and Dust enter your home.

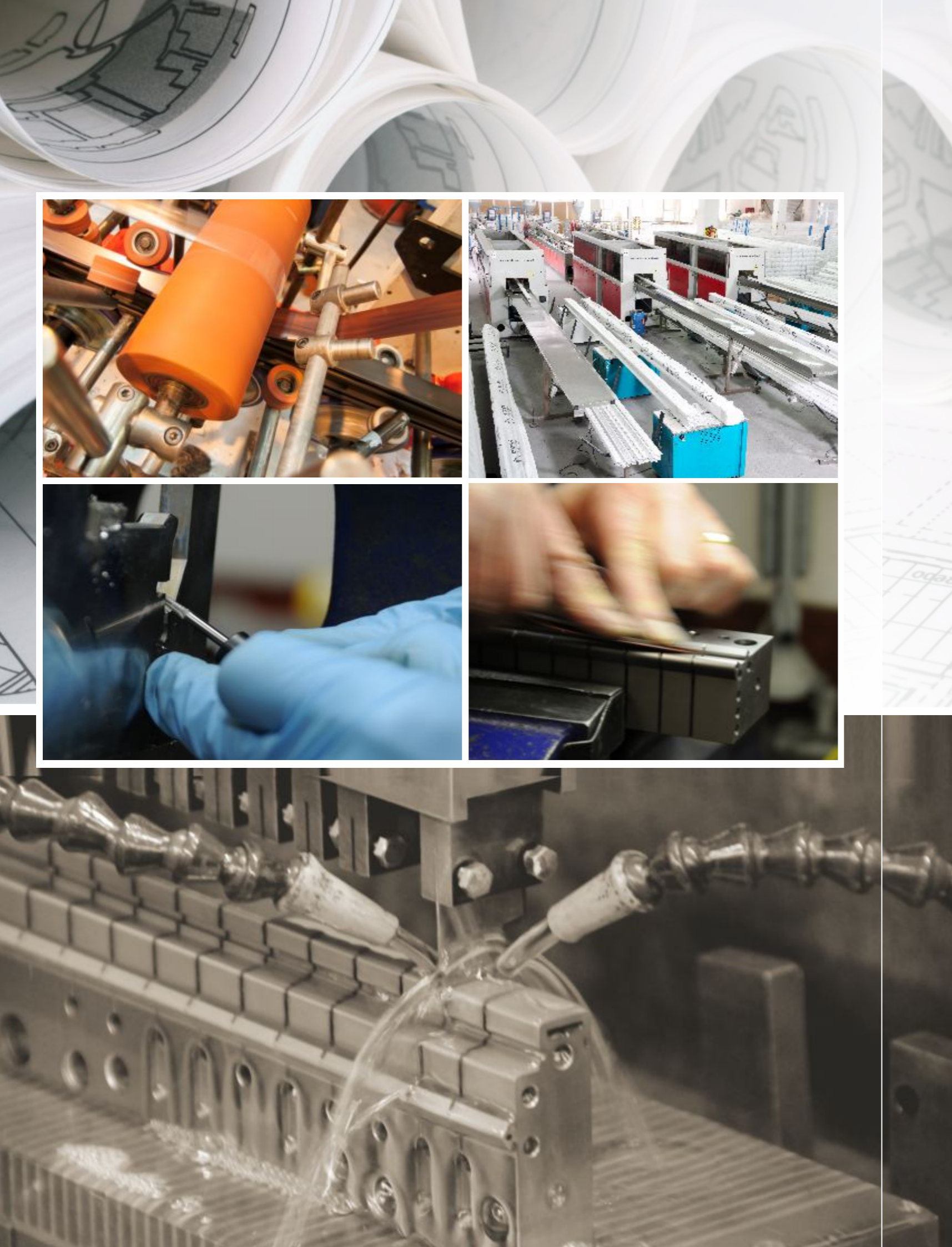

Visionary

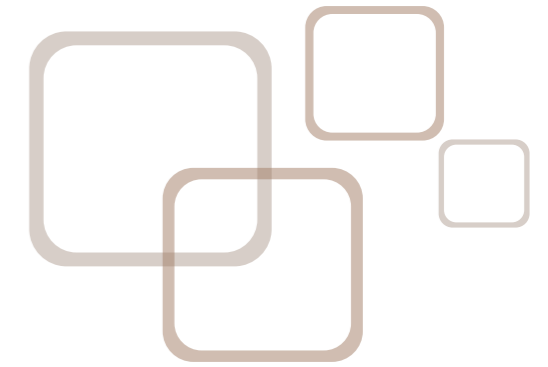

A Foundation for Futuristic Fenestration



Doors and Windows have undergone a sea of changes in the modern buildings. Universally, architects and builders have acknowledged that uPVC Doors & Windows are of engineered quality and can be customized to any size. Their aesthetical good looks, their ease of installation and their undisputable long term benefits have convinced architects, builders and consumers alike. ENCRRAFT uPVC frames can comfortably house bigger sheets of glass due to their inherent deeper glazing rebates which are a stringent requirement for combating India's higher wind pressures.

ENCRRAFT Door & Window systems give matchless support to a wide range of glass thickness. Available in a varied range of contemporary styles and designs in white and natural wood finishes, ENCRRAFT Systems render Strength, Beauty and Convenience to doors and windows of any size.



Stylish

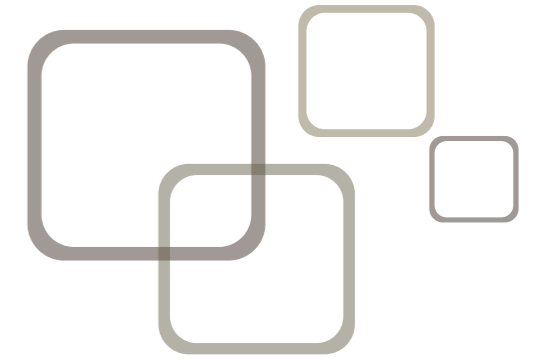

Making a masterpiece of Windows & Doors



Providing complete window solutions, from initial design to production and final installation of window systems for both home and commercial use, ENCRAFT systems are number one in styling and a benchmark for engineering precision. ENCRAFT systems come in a range of shapes and sizes, are custom designed to suit the local requirements, fabricated to exact dimensions and fitted-to-suit the particular requirement options. Be it any design or specification, ENCRAFT has a solution – of style and elegance to meet all expectations.

Practical

Casement Windows

ENCRAFT Casement Window range are designed to provide the maximum flexibility for fabricators and clients alike. The system is based on a two profile depths - 42 and 62 mm and was designed to facilitate maximum application coverage with the minimum number of profile sections providing fabricators and clients at the same time with the ideal range of products to suit any window replacement program or building type in the fast growing construction industry.

- Contemporary modern soft line profile appearance
- 10 mm sash overlap for enhanced performance
- Internal glazing options from 4 mm single to 36 mm triple
- Choice of single or multi - point locking devices
- Build - in hardware location facility for hinges, striker etc
- Secure hardware fitting into steel reinforcements as standard

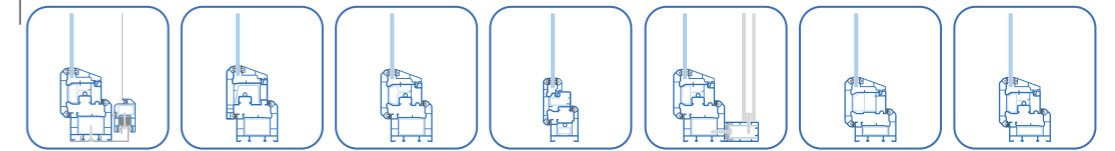

Sliding Windows

ENCRAFT Sliding Window range are designed to provide the maximum flexibility for fabricators and clients alike. Based on a range of sections, it offers full flexibility offering from single sliding to multiple sliding openers, clip on or integrated sections for fly screen and a range of section sizes covering small and large openings. It provides the ideal range of products to suit any window replacement program or building type in the fast growing construction industry.

- One, two and three track sliding, window and fly screen options
- Multi - chamber profile design, frame depth from 62 to 112 mm
- 10 mm sash overlap for enhanced performance
- Internal glazing options from 4 mm single to 22 mm double
- Choice of single or multi - point locking device
- Hardware components fastened into steel or 3 walls or Upvc

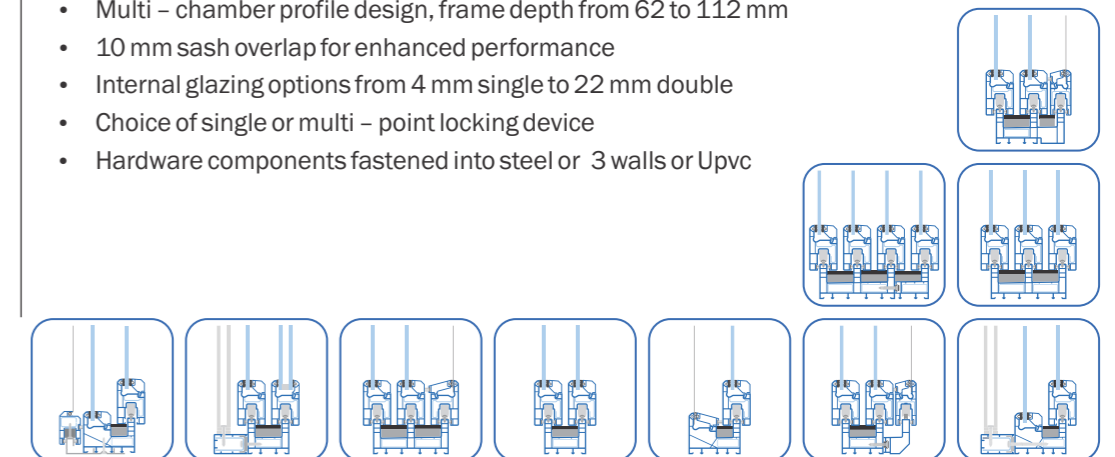

Revolutionary

TwinSash Windows

ENCRAFT TwinSash Windows are designed to provide ultimate flexibility for fabricators and clients alike. It provides the option of combining the traditional casement window with traditional inward opening fly screen option. There is a facility to incorporate a security grill or blinds for security or privacy. It also offers an additional variant of sash with integrated louvers with fly screen option. It was designed to facilitate maximum application coverage with the minimum number of profile sections providing fabricator and at the same time the end user with the ideal range of products.

- Contemporary modern soft line profile appearance
- Design compatibility with the EN casement and sliding range
- 10 mm sash overlap for enhanced performance
- Integrated solution for security grill and fly screens
- Choice of single or multi – point locking devices
- Secure hardware fitting into steel reinforcements as standard

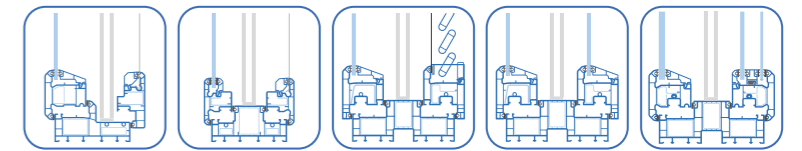

Vertical Slider Windows

ENCRAFT Vertical Slider Windows, a traditional fenestration concept that has become the perfect solution for ancillary frames when the opening aperture is taller than width i.e. reference golden ratio 1: 1.618, and when one opening sash is required for ventilation and/or fire escape! Its simple operation is based on a pair of frame specific, site tensioned, spiral balances that can hold the sash open in any position. The spiral balance technology has successfully replaced the traditional weights and pulleys method because of requiring less space enabling the modern uPVC vertical slider to fit perfectly into both aperture types, straight through or reveal.

- Contemporary modern Softline appearance
- 10 mm sash overlap for enhanced performance
- Internal glazing option from 4 mm single to 22 mm double
- Integrated handle bead for ease of operation
- Special spiral balances made to suit sash weight and frame size
- Opening sash secured with espagnolette locking device

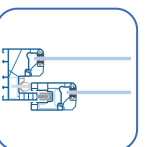



Energy Efficient

Tilt N Turn Windows

ENCRAFT Tilt N Turn Windows are designed to provide a European window option for fabricators and clients alike. The window is available as part of the EN62 range and was designed to give the discerning end user a state of the art inward opening fenestration solution. The ENCRAFT Tilt N Turn provides the client maximum design freedom due to larger opening sizes that can be achieved and suits any window replacement program or building type in the fast growing construction industry.

- Contemporary modern soft line profile appearance
- 9 mm sash overlap for enhanced performance
- Internal glazing options for 4 mm single to 36 mm triple
- Concealed heavy duty hinges and multi - point locking as standard
- External sliding fly screen system
- Secure hardware fitting into steel reinforcements as standard

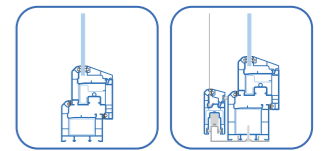

Parallel Windows

ENCRAFT Parallel Windows are designed for maximum ventilation and ideal for staircases, landings and offices. With a maximum sash size of 2 metres (6.6 feet) wide and 2 metres (6.6 feet) tall it caters for large openings, giving plenty of light to the area. With a weight carrying capacity of 200kg per sash the glazing options are almost limitless. There is a facility to incorporate a security grill or blinds for security or privacy.

- Can be inward or outward opening
- Glazing options from 4 mm single to 36mm triple
- Internal sash options with fly screen or glazed as above
- Integrated solution for security grill
- 3 frame options to choose from
- Multi point locking devices

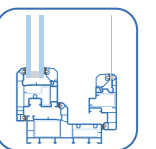

Elite

Fold & Slide Windows

ENCRAFT Fold N Slide Windows system offers superior operating performance and smooth integration into any architectural style and space. The window system is engineered to using multiple looking and with 2 to 6 panels the system offers unobstructed opening options. The hardware used offers a smooth glide and reliable performance with solid design and engineering.

- Can be opening in or out
- 2, 3, 4, 5 and 6 pane option
- Dedicated ENCRAFT top guide and bottom track to ensure perfect alignment
- Internal glazing option from 4mm single to 36mm triple glazing
- Frame width of up to 18'8" can be achieved with a maximum height of 9' not exceeding a sash weight of 100 kgs

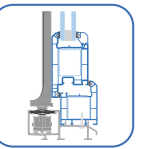

Futuristic

Tilt N Slide Doors

ENCRAFT Tilt N Slide Doors offer the ultimate in protection for your home. The European concept of tilting and sliding the door sash allows the provision of a dual compression seal and provides the maximum ventilation and glass area. The dual compression seal gives excellent insulation from sound and dust alike

- Contemporary modern soft line profile appearance
- Double Compression seals protect against draught, dust & water
- 9 mm sash overlap for enhanced performance
- Internal glazing options from 4 mm single to 36 mm triple
- Multi-point perimeter locking and heavy duty tandem rollers as standard
- Secure hardware fitting into steel reinforcements as standard

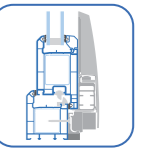

Fold N Slide Doors

ENCRAFT Fold N Slide Doors system provides superior operating performance and smooth integration into any architectural style and space. The door system is engineered using high quality uPVC Window and Door profiles and superior hinge and locking systems that are reliable and secure. The rollers along which the doors slide, offer a smooth glide and reliable performance with solid design and expert engineering.

- Contemporary modern Softline appearance
- 9 mm sash overlap for enhanced performance
- Internal glazing option from 4 mm single to 36 mm double
- Multi-point perimeter locking devices as standard
- Heavy duty tandem rollers for smooth operation
- Secure hardware fitting into steel reinforcements as standard

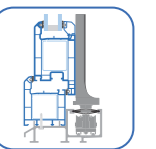

Innovative

Casement Doors

ENCRAFT Single or Double Casement Doors, suitable for opening-in and opening-out mode, can be used as main entrance door or as ancillary door leading onto corridors, Patios or balconies. Casement doors are available in 62 mm or 112 mm profile depth, can be manufactured as stand-alone items or part of a screen incorporating fan lights and/or side lights. Double doors also known as French doors can be used as an alternative to sliding Patio doors, especially, when a clear wide opening is being desired.

- Contemporary modern Softline appearance
- 9 mm sash overlap for enhanced performance
- Internal glazing option from 4 mm single to 36 mm double
- Choice of numerous multi-point locking devices including full perimeter locking
- Threshold-less or Aluminium low threshold
- Choice of hinge types including concealed (invisible) hinges

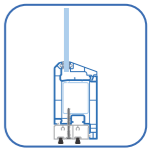

TwinSash Doors

ENCRAFT TwinSash Doors are probably the most ingenious door invented in India comprising two independently operated door sashes, one sash opening-out for mosquito screen and one sash opening-in for glazing. However, some parts of India may only require one sash equipped with mosquito screen whilst the second sash houses fixed or adjustable louvres. TwinSash doors can utilise ENCRAFT's two dedicated, door sashes and wide range of locking devices. For today's requirement, the ultimate TwinSash door comprises an external mosquito screen with a high performance double glazing unit incorporating blinds

- 152 mm outer frame depth with 56 mm available space between sashes
- 9 mm sash overlap for enhanced performance
- Internal glazing option from 4 mm single to 36 mm double
- Possibility to combine mosquito screen, panel, louvres and glass within one unit
- Choice of locking devices and hinge types including concealed (invisible) hinges
- Threshold-less

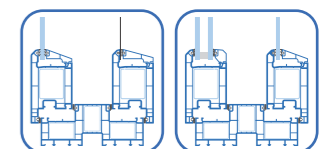

Creative

Balcony Doors

ENCRAFT Balcony Doors are intended to provide more glass area due to an overall, slimmer frame sight line and are available as either single or double doors (French doors), opening-in or opening-out, and are offered with one operating handle by design which is positioned inside. A special handle and a concealed snap-in device enables a temporary closing of the door when outside. Balcony doors can be stand-alone items or manufactured with fan lights and/or side lights or integrated into complete curtain walling screens.

- Contemporary modern Softline appearance
- 9 mm sash overlap for enhanced performance
- Internal glazing option from 4 mm single to 36 mm double
- Choice of numerous multi-point locking devices including full perimeter locking
- Threshold-less or Aluminium low threshold
- Choice of hinge types including concealed (invisible) hinges

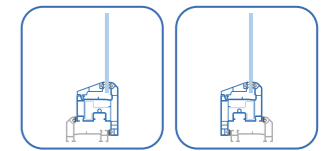

Lift N Slide Doors

ENCRAFT, the leading fenestration brand in the country, has given innovative fillip to traditional sliding and the result is - Lift n Slide Doors which are designed for larger openings for unobstructed views. By rotating the handle 180° the door fully lifts off its seals. ENCRAFT'S hallmark engineering precision ensures ease of function in both operations, that is, sliding and lifting.

- Easy handling due to perfectly aligned system technology
- Double compression seals protect against draught, dust & water
- Internal glazing options from 4 mm single to 36 mm triple
- Heavy duty tandem rollers for smooth operation
- Secure hardware fitting into steel reinforcements as standard
- Energy saving due to excellent thermal property

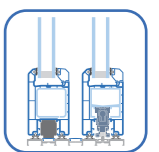

Heavy Duty Patio Doors

Modern frame apertures are getting bigger and the demand for more glass and less vertical divisions by frame members is also increasing. ENCRAFT's Heavy Duty Patio Doors can comply with those new challenges with its 2-pane version which can be manufactured up to 5.8 meters wide and up to 3.0 meters tall, accepting a maximum sash weight of 300 kg. The overall outer frame depth of 142 mm housing two 62 mm deep sashes is perfectly suited for modern straight through apertures. The effortless operation of the heavy sash (es) is achieved by using tandem rollers with a high weight carrying capacity, ENCRAFT's solid Aluminium threshold construction and a good gripping D-handle, anchored into the concealed sash steel.

- Available options 2-track (142 mm depth), 3-track (222 mm depth) and 4-track (302 mm)
- Unique Aluminium low threshold option for 2-track, 3-track and 4-track
- Internal glazing option from 4 mm single to 36 mm double
- Aluminium interlock for added rigidity equipped with double seal
- Heavy-duty tandem roller and multi-point lock as standard
- Optional mosquito screen and/or centre-pane/4-panel adapter

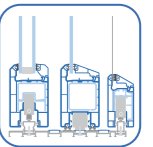

Ergonomical



French Doors

ENCRAFT French Doors, also known as double doors or double windows, are a pair of glass doors usually opening from the back of a house into its garden or onto its balcony. This concept of opening both sashes fully without seeing a centre obstruction has influenced French architecture since the 17th century. The whole grace and dignity of many European buildings was based on this majestic design principle. Modern fenestration adopted the uniqueness of French doors and French windows, mainly upgrading the design for high performance glazing and sophisticated locking devices whilst retaining the original character.

- ENCRAFT casement sashes are suitable for French doors and French windows
- Available in opening-out and open-in mode
- Internal glazing option from 4 mm single to 36 mm double
- Choice of numerous multi-point locking devices including full perimeter locking
- French doors are available threshold-less or with Aluminium low threshold
- Choice of hinge types including concealed (invisible) hinges

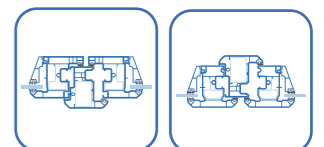

Unique

Low Threshold Doors

High performance in terms of air and water tightness, dust, insects, sound reduction requires sealing of the full sash perimeter. Any low threshold or threshold-less arrangement will compromise the performance aim but traditional living habits combined with ergonomics are today's overriding factors for fenestration. ENCRAFT is offering, wherever possible, Aluminum low threshold solutions or provide suggestions on how to prepare ground levels to hide the unwanted, high frame upstand associated with Fold & Slide Patio Doors and Tilt & Slide Patio Doors. ENCRAFT has chosen purposely Aluminum thresholds with silver anodised finish to provide a hard-wearing foundation for years of product durability.

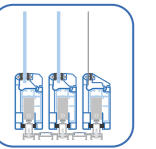

Sliding Doors

ENCRAFT Sliding Doors range covering frame depths from 62mm to 142mm is designed to provide the maximum flexibility for fabricators and clients alike. Based on a range of sections, it offers full flexibility from single sliding to multiple sliding openers, clip on or integrated sections for fly screen and a range of section sizes covering small and large openings.

- One, two and three track sliding, Patio door and fly screen options
- 10 mm sash overlap for enhanced performance
- Internal glazing options from 4 mm single to 22 mm double
- Choice of single or multi - point locking devices
- Hardware components fastened into steel or walls or uPVC
- Durable Aluminium track and anti - lift devices as standard

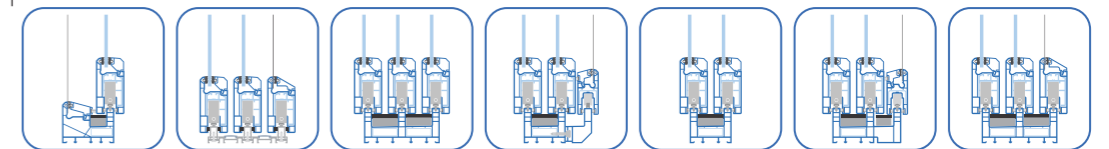
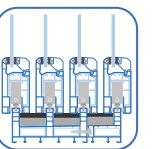



A treat to behold

ENCRAFT Door & Window systems come in a variety of wood finishes to suit a range of interiors and exteriors lending grace and beauty to the architectural design. The available attractive wooden shades are:

Dark Oak

Golden Oak

Walnut

Mahogany

Rustic Oak

Anthracite Grey

Attributes



Strong & Secure

ENCRAFT Door & Window systems have been engineered to allow the secure fitting of hinges, locking devices and handles providing a high level of security against intrusion and peace of mind. ENCRAFT systems are naturally flame retardant and decrease the fire load of a building fire.



Wind Load

ENCRAFT uPVC Door & Windows can withstand storms with wind pressure of over 3000 Pascal which is equivalent to a speed of 245 km/hr. This provides excellent application flexibility for today's modern high rise building structure.



Sensibly Green

ENCRAFT doors and windows are a superior option to wood and aluminium. Positive insulation reduces the carbon footprint of the building. 100% recyclable ENCRAFT systems are Lead free, thus increasing the environmental sustainability.



UV Resistant

ENCRAFT doors and windows systems are capable of protecting from high UV index. Entire process from raw material selection to advanced extruding to further processing is formulated to attain highest quality profiles capable to resist UV radiations which are generally high in Indian subcontinent.



Weather Resistant

Built with engineering precision, ENCRAFT's product range when installed in accordance with known installation guidelines like BS8213-4 will provide the perfect barrier against the elements. Rotting, splitting, warping or corroding, some of the problems associated with other frame materials will not happen with uPVC.



Energy Efficient

When it comes to thermal properties, uPVC is an excellent proposition for fenestration solutions due to its inherent warmth. All ENCRAFT's systems provide excellent thermal insulation, and the TwinSash can achieve as low as 0.8 W/m²K by using double glazed units. This makes the TwinSash from ENCRAFT a truly energy efficient, comfortable and affordable fenestration solution for all markets.



Sound Insulation

ENCRAFT uPVC Door & window systems utilize a multi-chambered profile design with double seal technology that ensures excellent insulation against sound infiltration. Installed with appropriate glazing, sound reductions up to 40 dB (decibels) are achievable.



Self Extinguishing

uPVC is difficult to ignite, if ignited and the source of flame is taken away, uPVC self extinguishes. uPVC will not support combustion and will not spread the fire on its own. uPVC has one of the lowest surface spread of flame ratings of all materials.

Supremacy

As a producer of profile, we share the responsibility of caring for the environment. We utilise lead free stabiliser in windows and doors and apply more stringent tests than the standard requires.

ENCRAFT Lead free compound achieves excellent colour fastness results

Colour fastness test results in accordance with EN 510
Max. change in colour between exposed and unexposed faces shall not be $\Delta E > 5.0$ and $\Delta b > 3.0$ in accordance with EN 12608 clause 5.8.3.

| Hours | L value | a value | b value | ΔL | Δa | Δb | ΔE |
|----------|---------|---------|---------|------------|------------|------------|------------|
| 0 | 94.36 | -0.60 | 1.45 | | | | |
| 1000 | 93.73 | -0.61 | 1.18 | 0.63 | 0.01 | 0.27 | 0.69 |
| 2000 | 95.16 | -0.57 | 0.87 | -0.80 | -0.03 | 0.58 | 0.99 |
| 3000 | 95.10 | -0.59 | 0.36 | -0.74 | -0.01 | 1.09 | 1.32 |
| 4000(M) | 93.11 | -0.60 | 0.62 | 1.25 | 0.00 | 0.83 | 1.50 |
| 5000 | 93.21 | 0.05 | 0.65 | 1.15 | -0.65 | 0.80 | 1.55 |
| 6000(S) | 95.16 | -0.67 | 0.49 | -0.80 | 0.07 | 0.96 | 1.25 |
| 7000 | 95.13 | -0.67 | 0.49 | -0.77 | 0.07 | 0.96 | 1.23 |
| 8000 | 93.97 | -0.67 | 0.54 | 0.39 | 0.07 | 0.91 | 0.99 |
| Averages | 94.33 | -0.55 | 0.74 | 0.04 | -0.06 | 0.80 | 1.19 |

ENCRAFT Lead free compound Material data

| Material properties conforming to BS EN 12608 | Reference standard | Standard values | ENCRAFT values |
|--|--------------------|-------------------------|--------------------------|
| Flexural modulus of elasticity | BS EN ISO 178 | >2200 N/mm ² | 2492 N/mm ² |
| Charpy Impact strength | BS EN ISO 179-2 | >20 KJ/m ² | av. 35 KJ/m ² |
| Vicat softening point | BS EN ISO 306-B | >75 °C | 80°C |
| Impact strength after artificial weathering | BS EN 513 | >40% | av.56% |
| Colour fastness after 6000 hrs climate zone 5 (severe) | BS EN 513 | $\Delta E < 5$ | $\Delta E = 1.25$ |
| Colour fastness after 6000 hrs climate zone 5 (severe) | BS EN 513 | $\Delta B < 3$ | $\Delta b = 0.96$ |
| Weldability (compression welding test) | BS EN 514 | >35 N/mm ² | av. 50 N/mm ² |
| Tensile impact strength | EN ISO 8256 | >600 KJ/m ² | 750 kJ/m ² |

